

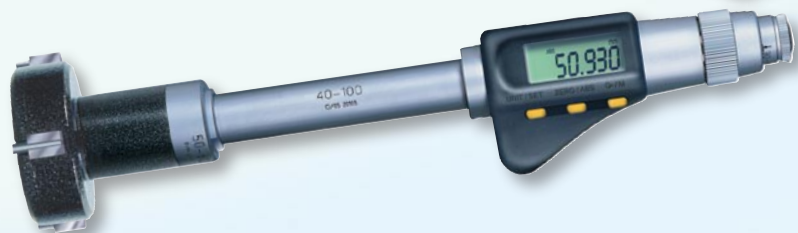

## Micromaster Alesometer

- Internal measuring with 3-line contact
- Specially suited for through and blind bores



Catalog No.	EDP No.	Range	List Price	Sale Price
62.90051	28418	0.2362-0.3150"/6-8 mm	<b>\$1,047.00</b>	<b>\$942.30</b>
62.90052	28419	0.3150-0.3970"/8-10 mm	<b>\$1,047.00</b>	<b>\$942.30</b>
62.90023	28420	0.3970-0.4921"/10-12.5 mm	<b>\$1,180.00</b>	<b>\$1,062.00</b>
62.90024	28421	0.4921-0.5905"/12.5-15 mm	<b>\$1,180.00</b>	<b>\$1,062.00</b>
62.90025	28422	0.5905-0.6890"/15-17.5 mm	<b>\$1,180.00</b>	<b>\$1,062.00</b>
62.90026	28423	0.6890-0.7874"/17.5-20 mm	<b>\$1,180.00</b>	<b>\$1,062.00</b>
62.90027	28424	0.7874-0.9843"/20-25 mm	<b>\$1,201.00</b>	<b>\$1,080.90</b>
62.90028	28425	0.9843-1.1811"/25-30 mm	<b>\$1,201.00</b>	<b>\$1,080.90</b>
62.90029	28426	1.1811-1.3780"/30-35 mm	<b>\$1,201.00</b>	<b>\$1,080.90</b>
62.90030	28427	1.3780-1.5748"/35-40 mm	<b>\$1,201.00</b>	<b>\$1,080.90</b>
62.90031	28428	1.5748-1.9685"/40-50 mm	<b>\$1,301.00</b>	<b>\$1,170.90</b>
62.90032	28429	1.9685-2.3622"/50-60 mm	<b>\$1,301.00</b>	<b>\$1,170.90</b>
62.90033	28430	2.3622-2.7560"/60-70 mm	<b>\$1,393.00</b>	<b>\$1,253.70</b>
62.90034	28431	2.7560-3.3465"/70-85 mm	<b>\$1,393.00</b>	<b>\$1,253.70</b>
62.90035	28432	3.3465-3.9370"/85-100 mm	<b>\$1,393.00</b>	<b>\$1,253.70</b>
62.90036	28433	3.9370-4.9212"/100-125 mm	<b>\$1,773.00</b>	<b>\$1,595.70</b>
62.90037	28434	4.9212-5.9055"/125-150 mm	<b>\$1,920.00</b>	<b>\$1,728.00</b>
62.90038	28435	5.9055-6.8897"/150-175 mm	<b>\$2,096.00</b>	<b>\$1,886.40</b>
62.90039	28436	6.8897-7.8740"/175-200 mm	<b>\$2,243.00</b>	<b>\$2,018.70</b>
62.90040	28437	7.8740-8.8582"/200-225 mm	<b>\$2,387.00</b>	<b>\$2,148.30</b>
62.90041	28438	8.8582-9.8425"/225-250 mm	<b>\$2,533.00</b>	<b>\$2,279.70</b>
62.90042	28439	9.8425-10.8267"/250-275 mm	<b>\$2,678.00</b>	<b>\$2,410.20</b>
62.90043	28440	10.8267-11.8110"/275-300 mm	<b>\$2,823.00</b>	<b>\$2,540.70</b>

## INTRIMIK Internal Micrometers

with Analog Indication (Inch Models)

### Features:

- Intrimik measuring arms move at right angles to the spindle
- Analog reading, with graduations as shown in the table
- Instruments in the range .275" to 4.00" have hardened steel measuring points (770 HV)
- Instruments in the range 4.00" to 12.00" have tungsten carbide inserts in the measuring points (1300 HV)



Catalog No.	EDP No.	Range	Smallest Division	Measuring Depth (in.) with Extensions			List Price	Sale Price
				None	One	Two		
599-281-3	43972	.275 to .350	.0001	2	6	10	<b>\$502.00</b>	<b>\$452.00</b>
599-281-4	43974	.350 to .425	.0001	2	6	10	<b>\$504.00</b>	<b>\$454.00</b>
599-281-5	43976	.425 to .500	.0001	2	6	10	<b>\$507.00</b>	<b>\$456.00</b>
599-281-6	43978	.500 to .600	.0002	3	9	15	<b>\$534.00</b>	<b>\$481.00</b>
599-281-7	43980	.600 to .700	.0002	3	9	15	<b>\$519.00</b>	<b>\$467.00</b>
599-281-8	43982	.700 to .800	.0002	3	9	15	<b>\$532.00</b>	<b>\$479.00</b>
599-281-10	43984	.800 to 1.000	.0002	3	9	15	<b>\$567.00</b>	<b>\$510.00</b>
599-281-12	43986	1.000 to 1.200	.0002	3	9	15	<b>\$575.00</b>	<b>\$518.00</b>
599-281-14	43988	1.200 to 1.400	.0002	3	9	15	<b>\$584.00</b>	<b>\$526.00</b>
599-281-16	43990	1.400 to 1.600	.0002	3	9	15	<b>\$591.00</b>	<b>\$532.00</b>
599-281-20	43992	1.600 to 2.000	.0002	3	9	15	<b>\$673.00</b>	<b>\$606.00</b>
599-281-24	43994	2.000 to 2.400	.0002	3	9	15	<b>\$684.00</b>	<b>\$616.00</b>
599-281-28	43996	2.400 to 2.800	.0002	3	9	15	<b>\$725.00</b>	<b>\$653.00</b>
599-281-32	43998	2.800 to 3.200	.0002	3	9	15	<b>\$714.00</b>	<b>\$643.00</b>
599-281-36	44000	3.200 to 3.600	.0002	3	9	15	<b>\$754.00</b>	<b>\$679.00</b>
599-281-40	44002	3.600 to 4.000	.0002	3	9	15	<b>\$740.00</b>	<b>\$666.00</b>
00882701	27011	4.000 to 5.000	.0005	4	10		<b>\$1,160.00</b>	<b>\$1,044.00</b>
00882702	27012	5.000 to 6.000	.0005	4	10		<b>\$1,195.00</b>	<b>\$1,076.00</b>
00882703	20221	6.000 to 7.000	.0005	4	10		<b>\$1,227.00</b>	<b>\$1,104.00</b>
00882704	20222	7.000 to 8.000	.0005	4	10		<b>\$1,262.00</b>	<b>\$1,136.00</b>
00883201 *	20223	8.000 to 9.000	.0005	4	10		<b>\$1,646.00</b>	<b>\$1,481.00</b>
00883202 *	20224	9.000 to 10.00	.0005	4	10		<b>\$1,700.00</b>	<b>\$1,530.00</b>
00883203 *	20225	10.00 to 11.00	.0005	4	10		<b>\$1,755.00</b>	<b>\$1,580.00</b>
00883204 *	20226	11.00 to 12.00	.0005	4	10		<b>\$1,815.00</b>	<b>\$1,634.00</b>

\* Comes with 6" extension in finished wooden case.

### Full sets

Catalog No.	EDP No.	Range	List Price	Sale
00880100	20214	.275 - .500"	<b>\$1,553.00</b>	<b>\$1,398.00</b>
00880400	20215	.500 - .800"	<b>\$1,700.00</b>	<b>\$1,530.00</b>
00881200	20216	.800 - 1.600"	<b>\$2,523.00</b>	<b>\$2,271.00</b>
00881900	20217	1.600 - 4.000"	<b>\$4,643.00</b>	<b>\$4,179.00</b>
00882700	20218	4.000 - 8.000"	<b>\$6,179.00</b>	<b>\$5,561.00</b>

Includes setting rings and one extension.